



M/Y SKYE



LOCATION: Japan

ASKING PRICE: USD 6 500 000

Any yachts offered are subject to availability.
Particulars are believed correct but are not guaranteed, neither may they be used for contractual purposes.
All business is conducted in accordance with our Terms of Business - copy available on request.



MONACO
+377 9770 5200

FORT LAUDERDALE
+1 954 271 5165

LONDON
+44 203 795 2690

TOKYO
+81 3 6447 7154

info@yacht-zoo.com | www.yacht-zoo.com



TYPE:	M/Y
FLAG:	Jamaica
SHIPYARD:	Sunseeker
PROJECT #:	8712086
BUILD:	2020
LENGTH OVERALL:	26.3 m / 86.29 ft
BEAM:	6.47 m / 21.23 ft
DRAFT:	1.95 m / 6.4 ft
DISPLACEMENT:	67 t
HULL MATERIAL:	GRP
CLASS:	CE (Cat B), MCA, ISO
MCA COMPLIANT:	Yes
ENGINES:	Twin MTU 12V 2000 M96L (2x1950ps)
MAX SPEED:	30 kt
CRUISE SPEED:	12 kt
RANGE:	1500 nm
ACCOMMODATION:	8 Guests in 4 Staterooms

ACCOMMODATION

STATEROOMS - BELOW, MIDSHIP & FORWARD:

MASTER STATEROOM - Below, full width, double bed w/ensuite head/shower, TV/Music/Surround Sound.

VIP STATEROOM - Main deck, forward, double bed w/ensuite head/shower, TV/Music/Surround Sound.

PORT GUEST STATEROOM - Below, twin beds, w/ensuite head/shower, TV/Music/Surround Sound.

STARBOARD GUEST STATEROOM - Below, twin beds, w/ensuite head/shower, TV/Music/Surround Sound.

MONACO
+377 9770 5200

FORT LAUDERDALE
+1 954 271 5165

LONDON
+44 203 795 2690

TOKYO
+81 3 6447 7154



MAIN DECK:

SALON - The salon has plenty of comfortable seating w/ 2 built-in, L-shaped sofas, 2 coffee tables, 2 chairs and full entertainment system w/surround sound.

DINING - The dining area is just forward of the salon w/ a large dining table for 8.

AFT DECK - The aft deck or cockpit is accessible through the salon (or from exterior - port or starboard). The aft deck is open-air and covered for shade w/ dining table and built-in seating for al fresco dining. A convenient refrigerator for drinks and sink are available also.

GALLEY - The galley is located forward of the dining area. A small counter w/seating as well as a built-in bankette for dining.

DAY HEAD - A small day-head is located between the dining area and the galley.

HELM CONSOLE - Also forward is the Helm / Observation area w/ leather seats, cameras, TV, Surround Sound, navigational and monitoring equipment.

BELOW AFT:

ENGINE ROOM - Located midship and aft is the engine room.

CREW QUARTERS - Aft are crew quarters for 4, small kitchenette w/ built-in dining bankette, 2 cabins w/ upper-lower bunks, TV/Music/Surround Sound, shared head w/ shower.

Below and all the way aft is the swim platform w/ hand-held shower for rinsing. The platform has an hydraulic lift to manage the Tender.

FOREDECK:

SUN DECK - Forward of the observation area is ample sunpad area for sunning as well as built-in seating and table for drinks or snacks or cocktails and appetizers.

UPPER DECK:

FLYBRIDGE - Lots of comfortable seating for lounging or dining and drinks well. A very large space with padded cushions for sunbathing. A full wet bar w/ seating is available plus a Jacuzzi tub for relaxing.

CAPACITIES

Fuel - 2,907 gals / 11,000 ltrs

Fresh Water - 370 gals / 1,500 ltrs

Black Water - 115 gals / 435 ltrs

Crew Black Water - 35 gals / 135 ltrs

ELECTRICAL

Shore Power - 2 x power inlets: 100A 200V 50/60HZ Glendinning / 2nd - 50A 220V 50/60HZ w/shore power plug and loose lead.

Generators - 2 x ONAN 29MDKDS 60HZ 240V 24V

Interior Electrical - Upgraded to a 5KVA inverter

Sea Exchange Spot Zero Water maker combined water softener



Air Conditioning

Tropical specification 3 x 24000BTU

Air Conditioning air handlers upgraded to quieter running WhisperCool DC fans

COMMUNICATIONS AND NAVIGATIONAL EQUIPMENT

Main Console Navigation.

Simrad NSO processor with Simrad OP50 Controller.

Three x Hatteland 'System X' 19" Glass Bridge Displays - two for navigation and one for monitoring.

Simrad Halo 6 Pulse Compression Radar 72nm 6 foot open array radar scanner.

Simrad GS25 GPS Antenna.

Simrad Autopilot system with control from QS80 Joystick and IS42 display.

Simrad IS42 Multifunction Instruments x 2 - displaying navigation information.

Simrad BSM-1 Sounder module with B744V speed depth transducer.

Simrad RS90 VHF with DSC.

Simrad AIS NAIS 400 Class B AIS Transponder system with integrated GPS receiver.

Observation area 28-Inch Roku Smart LED TCL 28S305 Television mounted to outboard port by seating group on bracket with 2 Monitor Audio MA PLICII surround speakers with back boxes and Cabling

Flybridge

Simrad NSS16 evo3 16" Chart plotter multifunctional displays x 2

Simrad Autopilot system with QS80 control.

Simrad IS42 Multifunction Instruments x 2 - displaying speed, depth and Compass.

Simrad second station RS90 VHF with DSC

MECHANICAL, PROPULSION AND ENGINE ROOM EQUIPMENT

Twin MTU 12V 2000 M96L (2 x 1950ps)

Sleipner hydraulic stabiliser units with Vector fins for underway and at anchor stabilisation

Bow thruster system - Sleipner SP550HYP

Stern thruster system - Sleipner SP550HYP

GALLEY, DOMESTIC AND LAUNDRY EQUIPMENT

Custom Galley Refrigeration by Frigoboat with stainless steel interior and exterior.

250 litres fridge capacity and 120 litres freezer capacity

Miele KM6520 FR 4 ring ceramic hob

Miele Electric oven H2161B

Miele Microwave M6022 SC



Bosch DHL535B hob extractor fan
Miele full size Dishwasher G6860 SCVi

Dining

Wine cooler U-Line 3060ZWC in the Forward cabinet

Flybridge

Electric Ceramic fluted grill CDA - CD31 Domino griddle
Icemaker Victrofrigo Classic
Refrigerator Waeco 80 ltr CR80
Cool-chest with Waeco fridge plate CS NC15

Cockpit

Refrigerator Waeco 50 ltr CR50 Behind a vented GRP door

Crew mess

Miele WTF130 washing machine combined tumble dryer
Sharp Microwave R274 SLM
Waeco CR1080e refrigerator

ENTERTAINMENT EQUIPMENT

Salon

Sony 65" XBR-65A9F 4K television bulkhead mounted with locally fitted client supply Samsung UBD-M97000 DVD player.
Pepwave MAX-BR1-LTE-US-T US Router with Zone Director
2 MA 265IDC front speakers
2 x MA CSS 230 surround speakers with 1 WSS430 centre speaker and 2 MA CW8 Sub woofers.
External HDMI socket.

Dining

2 Monitor Audio AW280 speakers

Flybridge

Flybridge zone with Six Monitor Audio AW280 speakers plus 2 Monitor Audio AW265 units and 2 Sonance SR1 Subwoofers

Foredeck

Fore deck zone with Two Monitor Audio AW265 plus 2 Monitor Audio AW280 units with 1 Sonance SR1 Subwoofer
Side deck sliding door: 2 Monitor Audio AW280 speakers



Aft cockpit

Four Monitor Audio AW280 units and 1 Sonance SR1 Subwoofer

Master cabin

Samsung 55" UE55LS03NAUXXU The Frame Television with One connect box via 15 mtr control cable with a HDBaseT fitted locally along with External HDMI socket

Owner supply Monitor Audio MA PLICII x4 surround speakers with MA Back Boxes and 1 WSS430 centre speaker plus 1 MA CW8 Sub woofer

VIP cabin

Samsung 43" UE43LS03NAUXXU The Frame Television with One connect box via 15 mtr control cable with Sonos Connect and HDBaseT

Monitor Audio MA PLICII in ceiling speakers x2 with MA back boxes

Guest cabins

24" D24F-F1 Vizio Television with Apple TV and External HDMI fitted with Monitor Audio MA CSS 230 in ceiling speakers

Crew mess

24" D24F-F1 Vizio Television with Apple TV, Sonos Amp and External HDMI fitted locally with Monitor Audio MA

CT380IDC in ceiling speakers

DECK EQUIPMENT

Standard stern lockers

Spa Tub on the Flybridge aft deck

Besenzoni telescopic Passerelle

Hydraulically lifting platform with maximum lift capacity of 650 kg with Tender maximum weight of 550 kg

Flybridge carbon fibre hardtop, including retractable centre canopy and aft extending sun canopy with central canopy in Black Valmex 905000 top with Soft white mesh 191000 underliner

Underwater lights - Lumishore

2 x M9 size Dummy Domes finished in Black Gloss to be fitted to the hardtop arch

Twin Anchor arrangement at Bow.

2 x Lewmar V8 windlass.

1 x Lewmar 80kg Stainless steel anchor in lieu of galvanized with 100 metres 12mm diameter galvanized chain.

1 x Lewmar 50kg Stainless steel anchor in lieu of galvanized with 60 metres 12mm diameter galvanized chain.

Fresh water deck wash outlet



6 x Docking lines. 15 metre x 20mm 3 strand black with eye on one end
1 x Tender line. 10 metre x 10mm 3 strand black
8 x Fenders Majoni Mega F7, 35 x 110 cm in white
8 x Fender ties. 3.5 metre x 12mm 3 strand black
Mosquito screens for openable portlights

This document is not contractual. All specifications are given in good faith and offered for informational purposes only. YACHTZOO does not warrant or assume any legal liability for the accuracy, completeness or usefulness of any information displayed. Yacht availability, inventory, specifications and prices are subject to change without prior notice.

Any reproduction of the contents of this document for advertising in any medium in part or in its entirety is strictly forbidden without YACHTZOO's prior written consent.

MONACO
+377 9770 5200

FORT LAUDERDALE
+1 954 271 5165

LONDON
+44 203 795 2690

TOKYO
+81 3 6447 7154



MONACO
+377 9770 5200

FORT LAUDERDALE
+1 954 271 5165

LONDON
+44 203 795 2690

TOKYO
+81 3 6447 7154

info@yacht-zoo.com | www.yacht-zoo.com



MONACO
+377 9770 5200

FORT LAUDERDALE
+1 954 271 5165

LONDON
+44 203 795 2690

TOKYO
+81 3 6447 7154

info@yacht-zoo.com | www.yacht-zoo.com



MONACO
+377 9770 5200

FORT LAUDERDALE
+1 954 271 5165

LONDON
+44 203 795 2690

TOKYO
+81 3 6447 7154

info@yacht-zoo.com | www.yacht-zoo.com



MONACO
+377 9770 5200

FORT LAUDERDALE
+1 954 271 5165

LONDON
+44 203 795 2690

TOKYO
+81 3 6447 7154

info@yacht-zoo.com | www.yacht-zoo.com



MONACO
+377 9770 5200

FORT LAUDERDALE
+1 954 271 5165

LONDON
+44 203 795 2690

TOKYO
+81 3 6447 7154

info@yacht-zoo.com | www.yacht-zoo.com



MONACO
+377 9770 5200

FORT LAUDERDALE
+1 954 271 5165

LONDON
+44 203 795 2690

TOKYO
+81 3 6447 7154

info@yacht-zoo.com | www.yacht-zoo.com



MONACO
+377 9770 5200

FORT LAUDERDALE
+1 954 271 5165

LONDON
+44 203 795 2690

TOKYO
+81 3 6447 7154

info@yacht-zoo.com | www.yacht-zoo.com



MONACO
+377 9770 5200

FORT LAUDERDALE
+1 954 271 5165

LONDON
+44 203 795 2690

TOKYO
+81 3 6447 7154

info@yacht-zoo.com | www.yacht-zoo.com



MONACO
+377 9770 5200

FORT LAUDERDALE
+1 954 271 5165

LONDON
+44 203 795 2690

TOKYO
+81 3 6447 7154

info@yacht-zoo.com | www.yacht-zoo.com



MONACO
+377 9770 5200

FORT LAUDERDALE
+1 954 271 5165

LONDON
+44 203 795 2690

TOKYO
+81 3 6447 7154

info@yacht-zoo.com | www.yacht-zoo.com



MONACO
+377 9770 5200

FORT LAUDERDALE
+1 954 271 5165

LONDON
+44 203 795 2690

TOKYO
+81 3 6447 7154

info@yacht-zoo.com | www.yacht-zoo.com



MONACO
+377 9770 5200

FORT LAUDERDALE
+1 954 271 5165

LONDON
+44 203 795 2690

TOKYO
+81 3 6447 7154

info@yacht-zoo.com | www.yacht-zoo.com



MONACO
+377 9770 5200

FORT LAUDERDALE
+1 954 271 5165

LONDON
+44 203 795 2690

TOKYO
+81 3 6447 7154

info@yacht-zoo.com | www.yacht-zoo.com



MONACO
+377 9770 5200

FORT LAUDERDALE
+1 954 271 5165

LONDON
+44 203 795 2690

TOKYO
+81 3 6447 7154

info@yacht-zoo.com | www.yacht-zoo.com



MONACO
+377 9770 5200

FORT LAUDERDALE
+1 954 271 5165

LONDON
+44 203 795 2690

TOKYO
+81 3 6447 7154

info@yacht-zoo.com | www.yacht-zoo.com



MONACO
+377 9770 5200

FORT LAUDERDALE
+1 954 271 5165

LONDON
+44 203 795 2690

TOKYO
+81 3 6447 7154

info@yacht-zoo.com | www.yacht-zoo.com



MONACO
+377 9770 5200

FORT LAUDERDALE
+1 954 271 5165

LONDON
+44 203 795 2690

TOKYO
+81 3 6447 7154

info@yacht-zoo.com | www.yacht-zoo.com



YACHTZOO®

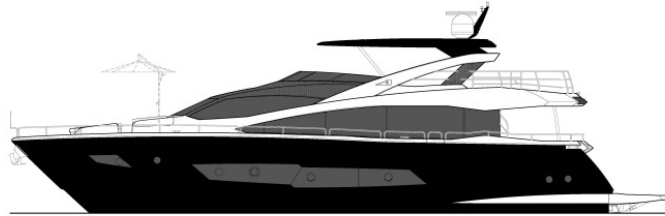

PROFILE

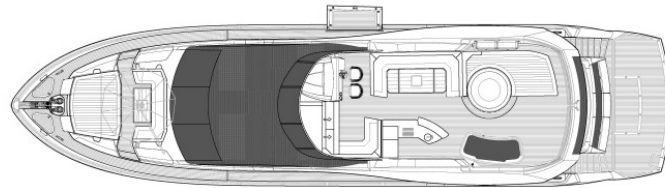

FLYBRIDGE

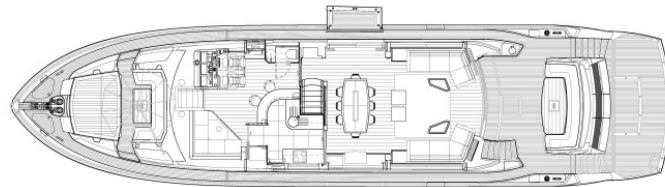

MAIN DECK



LOWER DECK

MONACO
+377 9770 5200

FORT LAUDERDALE
+1 954 271 5165

LONDON
+44 203 795 2690

TOKYO
+81 3 6447 7154

info@yacht-zoo.com | www.yacht-zoo.com